

27 V2

270mm Polyglass subwoofer



- Zamak chassis, 4 layers Kapton former voice-coil
- Polyglass cone, Butyl surround
- High power handling
- Deep frequency in small sealed box



Specifications

| | | |
|----------------|-------------|---|
| Nominal power | 300 W | |
| Maximum power | 600 W | |
| Sensitivity | 88 dB | |
| Cone | Polyglass | |
| Surround | Butyl | |
| Nom. impedance | 2 x 4 ohms | |
| DC resistance | 2.1 ohms | |
| VC diameter | 65 mm | 2 ^{9/16} in |
| VC height | 32 mm | 1 ^{1/4} in |
| Former | Aluminium | |
| Layers | 4 | |
| Wire | Copper | |
| Inductance | 2 mH | |
| Xmax | 11 mm | |
| Magnet d x h | 155 x 40 mm | 6 ^{1/8} x 1 ^{9/16} in |
| Magnet weight | 6400 g | 14.1 lb |
| Flux density | 0.75 T | |
| Gap height | 10 mm | 3/8 in |
| Net weight | 7.3 kg | 16.31 lb |

Suggested Application

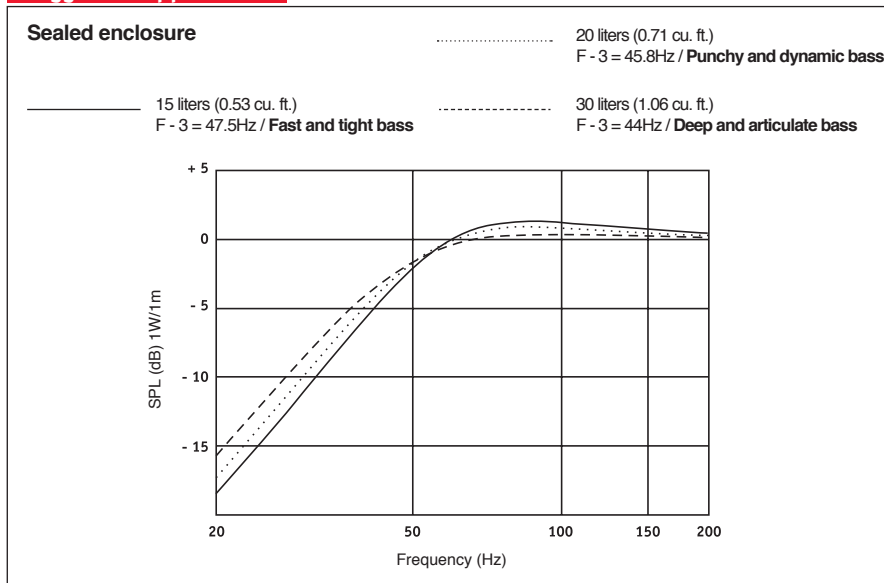

Parameters

| | | |
|-----|----------------------------|-----------------------|
| Fs | 38.51 Hz | |
| Vas | 21.34 l | 0.754 Ft ³ |
| Qts | 0.63 | |
| Qes | 0.71 | |
| Qms | 5.52 | |
| Re | 2.1 ohms | |
| Sd | 336.54 cm ² | |
| Cas | 1.52E-07 m ⁵ /N | |
| Mas | 112.42 kg/m ⁴ | |
| Ras | 4927.76 ohms.ac | |
| Cms | 1.34E-04 m/N | |
| Mms | 127.32 g | 0.28 lb |
| Rms | 5.581 Kg/s | |
| Ces | 1397.29 mF | |
| Les | 12.22 mH | |
| Res | 16.33 ohms | |
| Bl | 9.55 N/A | |
| SPL | 84.19 dB/W/m | |

Mechanical Drawing

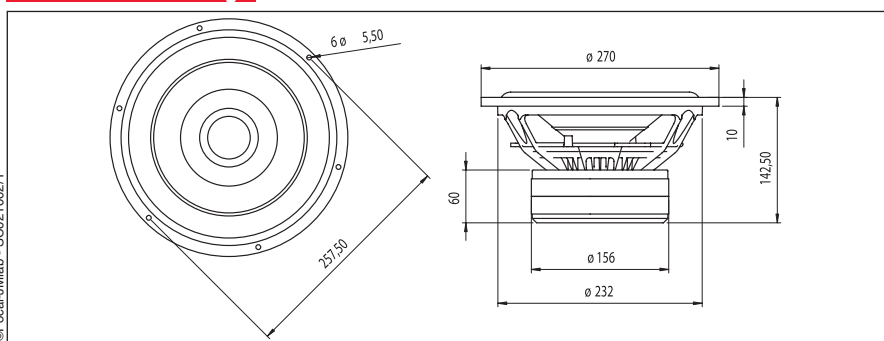

Suggested application

| Load | V (l) | Fb (Hz) | F-3 (Hz) | Ql |
|--------|-------|---------|----------|----|
| Vented | - | - | - | - |
| Sealed | - | - | - | - |

Focal® is a trademark of Focal-JMLab®