

# ANIGMO

Touchless Dimmer Switch With  
A Decorator Wall Plate

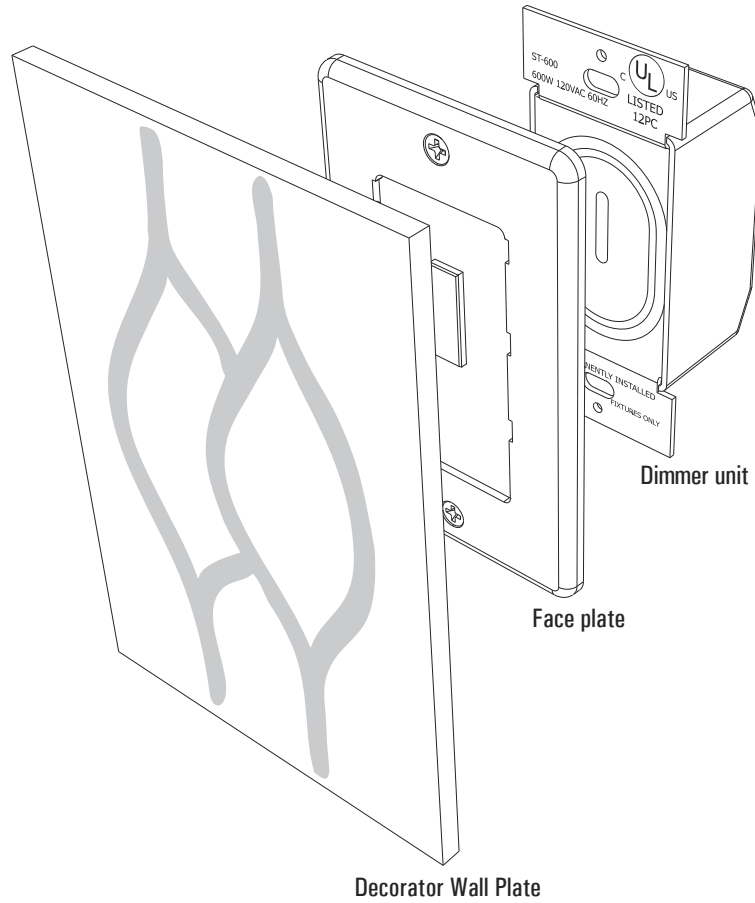

## Basic Operation

**To turn the light *ON* or *OFF*:**  
Wave your hand in front of the Decorator Wall plate.

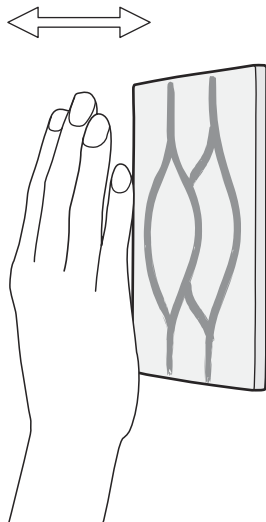

**To *DIM*:**  
Hold your hand over the Decorator Wall Plate until desired level of brightness is achieved.

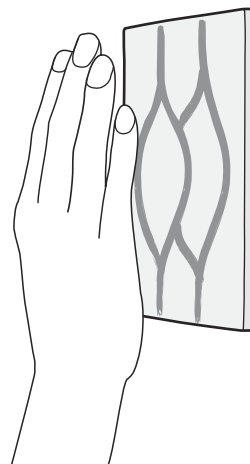

**To shut the Dimmer unit *OFF*:**  
Push the Decorator Wall Plate UP.

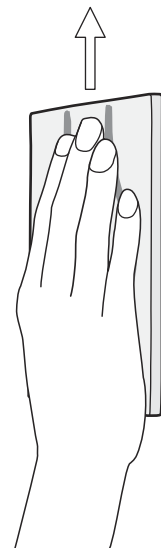

# ANIGMO

## Touchless Dimmer Switch

Incandescent / Low Voltage Magnetic Dimmer Switch

Model No. Anigmo 600, 600(M), (S), (LVM)

120VAC, 60Hz

UL File# E237047

### Important notes

#### CAUTION:

1. Read and understand these instructions before installing device. Before installing this unit, disconnect power at circuit breaker or remove fuse to avoid shock or damage to the unit. This device is intended for installation in accordance with the National Electric Code and local regulations. It is recommended that a qualified electrician perform this installation.
2. a: for dimmers controlling a tungsten-filament – “to reduce the risk of overheating and possible damage to other equipment, do not install to control a receptacle, a motor-operated appliance, a fluorescent lighting fixture, or a transformer-supplied appliance;”  
b: for dimmers controlling a low-voltage transformer – “to reduce the risk of overheating and possible damage to other equipment, do not install to control a receptacle or a motor-operated appliance.”
3. Single gang installation only.
4. Installation of this switch in proximity of strong EM (electro magnetic) interference such as (and not limited to): electrical welding machine, inadequately shielded power supplies, radars etc. could cause inadvertent switch activity.
5. This switch may not be used in any application in which the inadvertently changing the switch state could create a situation where personal injury or death may occur.
6. Do not use where total load wattage is less than 40W (40 VA).
7. Do not install in combination with standard 3-Way switches or third party remote control units. Use only in combination with Anigmo S remote unit.

### Contact

#### Anigmo

1040 Avenue of the Americas

New York, 10018 NY

Tel: 1 800 749 0518

Fax: 1 800 749 0519

Email: support@anigmo.com

www.anigmo.com

### Warranty

Anigmo will, at its opinion, repair or replace any unit that is defective in materials or manufacture within 5 years after purchase. For warranty service, return the unit to place of purchase. This warranty is in lieu of all other warranties, expressed or implied, and the implied warranty of merchantability is limited to 5 years from purchase. This warranty does not cover the cost of installation, removal or reinstallation, or damage resulting from misuse, abuse, or damage from improper wiring installation. This warranty does not cover incidental or consequential damages. This warranty gives you specific legal rights, and you may have other rights which may vary from state to state. Some states do not allow the exclusion or limitation of incidental or consequential damages or limitation on how long an implied warranty may last, so the above limitations may apply to you. This product is covered under US patents: 6750564. Foreign patents pending.

#### \*Load ratings

Dimmer type	Load type	Incandescent / Line volt. halogen	Low volt. magnetic
Anigmo 600		600W	DO NOT USE
Anigmo 600M		600W	DO NOT USE
Anigmo 600LVM		600W	600VA / 450W
Anigmo S		N/A	N/A

## INSTALLATION

1. **WARNING:** Turn power OFF at circuit breaker or remove fuse



2. Remove Existing switch from wall box.

3. Prepare the unit for installation by removing the two faceplate screws and the faceplate itself.

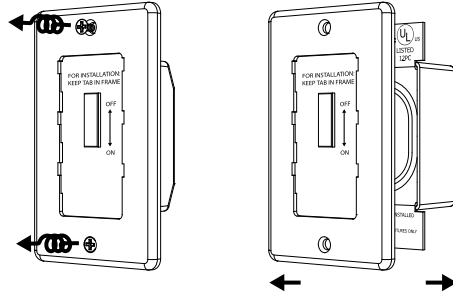

4. Connect wires as shown. Refer to wiring diagrams.

**IMPORTANT!!! - Make sure black wire is connected to HOT in the wall box.**

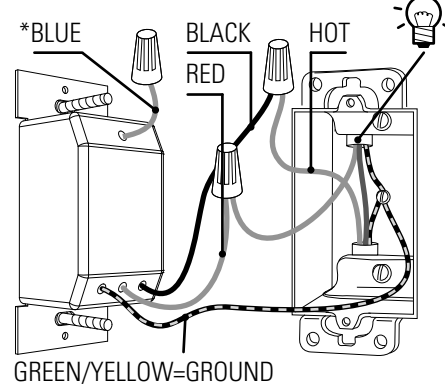

**\*Model Anigmo 600 does not have a BLUE wire**

Single location control

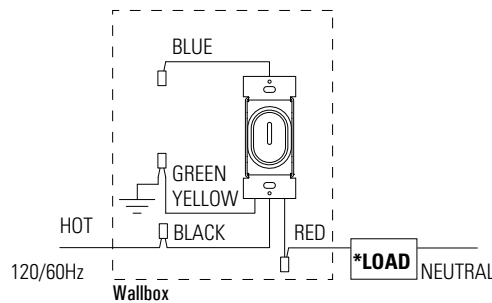

\*See Load ratings for more informations

Multi location control

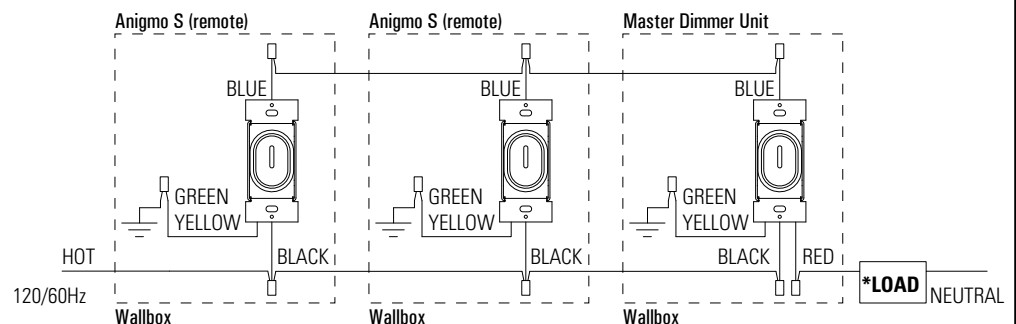

\*See Load ratings for more informations

5. Mount unit into wall box, align before tightening the screws

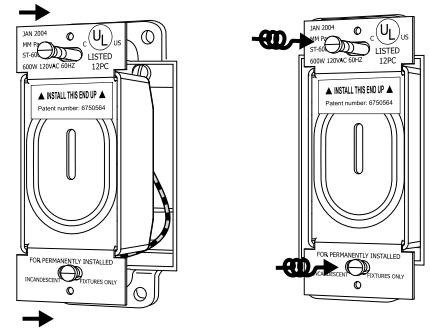

6. Before installing faceplate make sure tab is in the OFF (upper) position and arrows are pointing UP. Caution: Do not overtighten mounting screws.

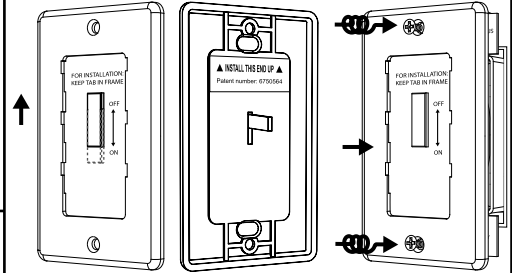

7. To install Decorator Wall Plate and activate the Dimmer unit

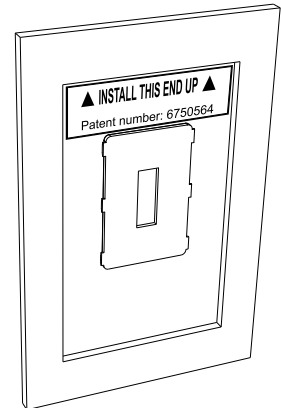

1. Make sure the tab is in OFF (UP) position.
2. Make sure that arrows on Decorator Wall Plate are pointing up.
3. Push Decorator Wall Plate against faceplate until it snaps in then slide it down approx. 1/2".
4. Remove hand away from the Dimmer unit, wait 10 seconds.
5. To deactivate the Dimmer unit simply slide the Decorator Wall Plate up.

8. Restore power at circuit breaker