

OUTSIDE DIAMETER: 18.174
 MATERIAL THICKNESS: .040
 INSIDE DIAMETER: 18.094

 (INSIDE RADIUS) $9.047 + (50\% \text{ MATERIAL THICKNESS})0.020 = (\text{RADIUS})9.067$

 (CIRCUMFERENCE) $C = \pi \times R^2$
 $C = 3.14159265 \times 18.134$
 $C = 56.970$
 $56.970 / 2 = 28.485$ (HALF BODY CIRCUMFERENCE)

CUTOUT LOCATION CHART				
CODE	X-AXIS COORD.	Y-AXIS COORD.	SIZE: "X" x "Y"	DESCRIPTION
A1	4.353	-1.181	3.000 x 12.854	LARGE RECESSED DOOR
A1	21.132	-1.181		
B1	8.015	-6.425	3.993 x 2.461	MEDIUM PANEL
C1	12.446	-6.425	3.593 x 7.534	CENTER VENTS
D1	16.477	-6.425	3.993 x 7.534	MEDIUM RECESSED DOOR
E1	8.015	-9.609	1.490 x 0.375	COIN SLOT
E2	8.015	-10.404		
E3	8.015	-11.199		
E4	8.015	-11.994		
E5	8.015	-12.789		
E6	8.015	-13.584		
F1	10.125	-9.609	1.883 x 4.350	SMALL RECESSED PANEL
G1	9.538	-14.465	1.969 x 1.260	X-SMALL HORIZONTAL PANEL
H1	12.446	-14.465	3.593 x 1.260	LARGE HORIZONTAL PANEL
I1	17.076	-14.465	3.393 x 1.260	MEDIUM HORIZONTAL PANEL
J1	21.132	-14.465	3.000 x 1.260	SMALL HORIZONTAL PANEL
K1	2.994	-14.465	4.359 x 4.571	VENT
L1	8.015	-16.161	3.993 x 2.875	COIN RETURN SLOT
M1	12.805	-16.161	2.875 x 2.875	POWER COUPLING
N1	16.477	-16.161	1.736 x 2.875	LARGE VERTICAL PANEL
O1	18.747	-16.161	1.012 x 2.875	SMALL VERTICAL PANEL
P1	20.293	-16.161	1.014 x 2.875	MEDIUM VERTICAL PANEL
Q1	22.159	-16.130		SEE DETAIL A
R1	19.468	-1.828		SEE DETAIL B
R2	9.016	-4.182		
S1	8.015	0.000	12.454 x 2.413	UTILITY ARM FRAME
S2	8.015	-5.888	12.454 x 3.535	

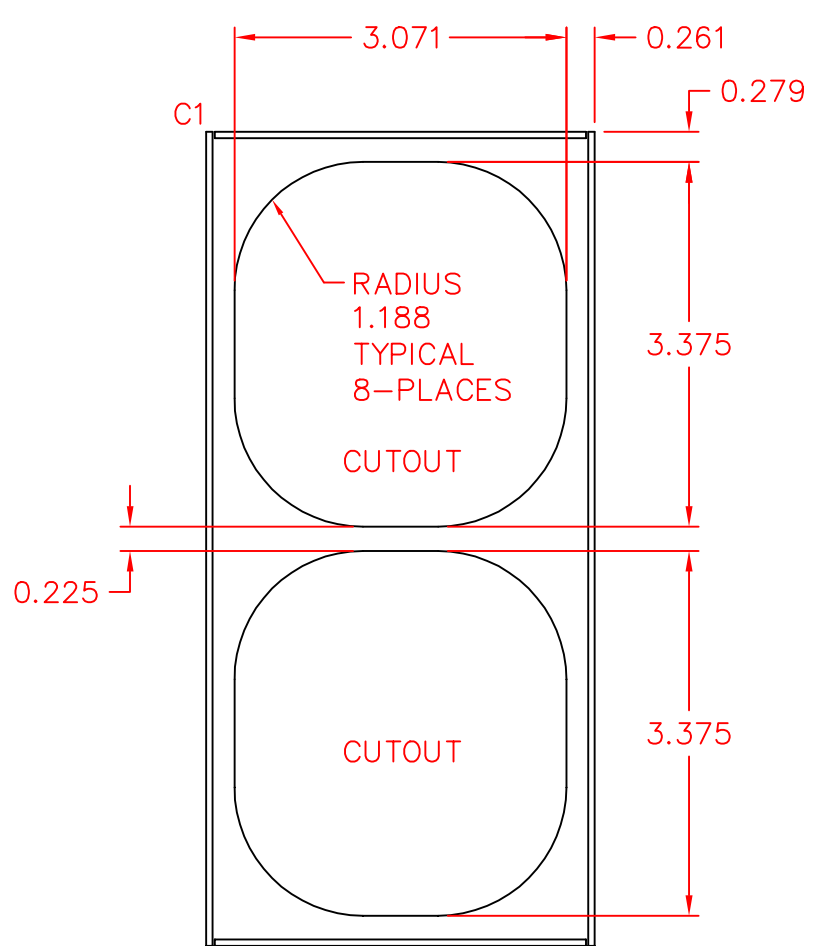

DETAIL C

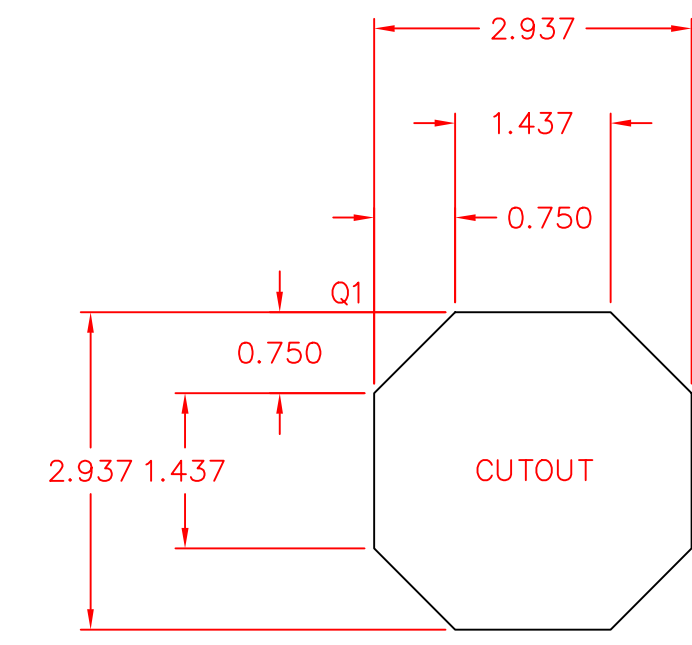

DETAIL A

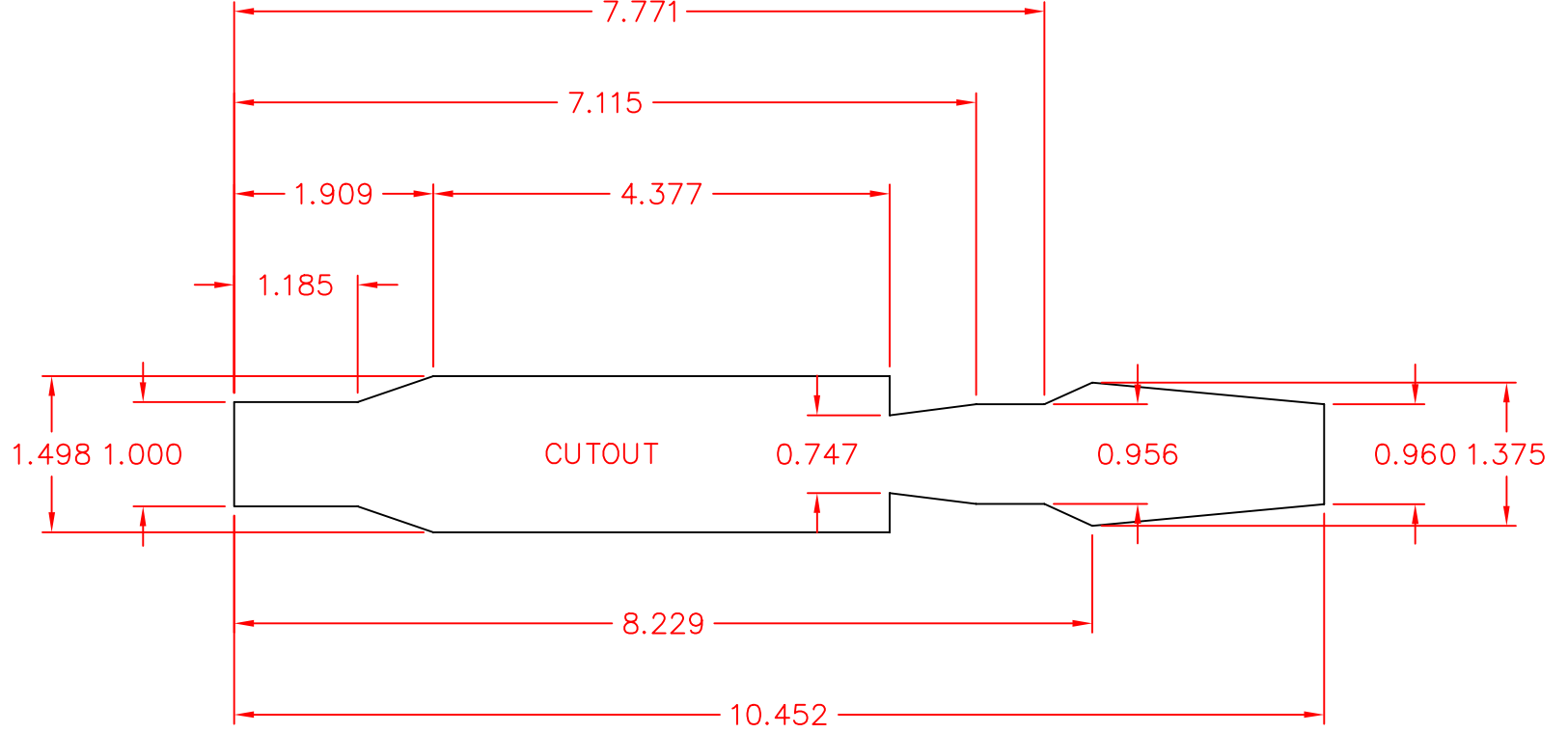

DETAIL B

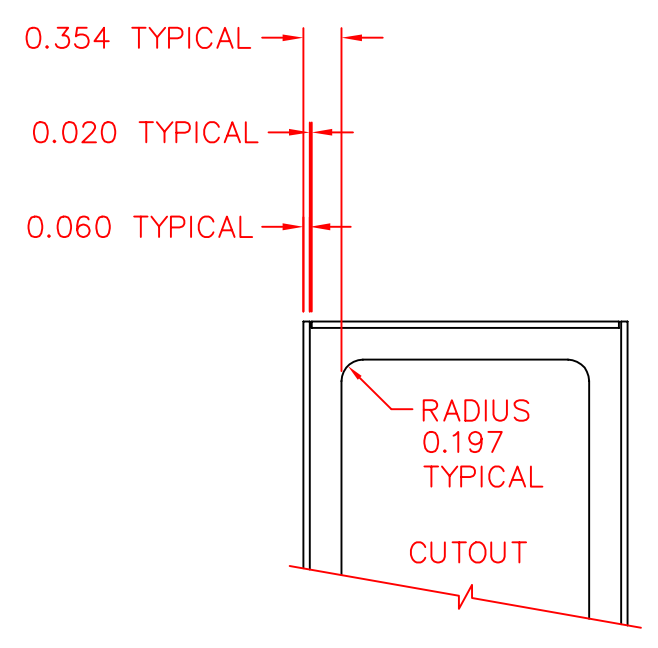

DETAIL D

JAG

SKIN-FRONT OUTER
R2-D2 BUILDERS CLUB

SIZE	FSCM NO.	DRAWING NO.	REV.
E			B

SCALE FULL | DRAWN JAG | 09/12/2002 | SHEET 1 OF 1