



---

# Service Manual

Freestanding Cooling

Double Door

ART 668/G

---

<b>Model Version</b>		<b>Page</b>
	ART 668/G	
	8564 668 10000	
	Technical data	2
	Spare part list	3
	Exploded view	4
	Circuit and Wiring diagram	5

## Technical data

### Dimensions

Height	181.3	cm
Width	59.5	cm
Depth	60.0	cm

### Capacity

<b>Total</b>		
gross	320	l
net	301	l
<b>Cooling</b>		
gross	205	l
net	200	l
<b>Freezing</b>		
gross	115	l
net	101	l

### Electrical connection

Voltage	220 - 240	V
Frequency	50	Hz

### Power consumption

in 24 hours	1.27	kWh
-------------	------	-----

### Freezing capacity

in 24 hours	10	kg
-------------	----	----

### Compressor

Manufacturer	EMBRACO	
Type	EMT 60 HLP	
Capacity (CECOMAF)	129	W

### Refrigerant

Type	R 134 a	
Quantity	120	g

### Thermostat switching value

Switch on temperature min.	+ 4.0	°C
Switch on temperature max.	+ 4.0	°C
Switch off temperature min.	- 16.0	°C
Switch off temperature max.	- 32.0	°C

## Spare part list

**Model** ART 668/G  
**Service No.** 856466810000  
**Version** 856466810000

Pos. No.	12NC Code	Description
011 0	<b>4812 462 79803</b>	Adjust.foot
011 1	<b>4812 462 48094</b>	Holder left
011 2	<b>4812 462 18213</b>	Holder right
024 0	<b>4812 400 18059</b>	Table top
041 1	<b>4812 417 19045</b>	Hinge, upper
041 3	<b>4812 417 19044</b>	Hinge, middle
045 5	<b>4812 404 78484</b>	Pin
047 0	<b>4812 404 48805</b>	Holder
047 1	<b>4812 404 38648</b>	Fastener
047 2	<b>4812 404 48809</b>	Fastener
070 0	<b>4812 460 88251</b>	Plinth
101 0	<b>4812 416 18475</b>	Door, freezer
104 0	<b>4812 416 18476</b>	Door, refriger.
104 2	<b>4812 462 28329</b>	Stopper
104 3	<b>4812 404 78489</b>	Clip fixation evap.
154 0	<b>4812 418 48557</b>	Door, dairy lower
154 5	<b>4812 418 48556</b>	Door, dairy upper
154 6	<b>4812 418 28281</b>	Separator
154 7	<b>4812 404 38649</b>	Holder right
154 8	<b>4812 404 38651</b>	Holder left
154 9	<b>4812 418 88992</b>	Lid
156 0	<b>4812 418 28282</b>	Holder, eggs
156 1	<b>4812 418 48554</b>	Icecube, tray
171 0	<b>4812 462 28331</b>	Profile
171 2	<b>4812 460 58382</b>	Profile
191 0	<b>4812 468 18108</b>	Magnetic seal
191 1	<b>4812 466 88614</b>	Gasket, door refr.
241 0	<b>4812 462 28328</b>	Cover lamp
242 0	<b>4812 418 48558</b>	Crisper
243 1	<b>4812 276 18381</b>	Switch
243 2	<b>4812 404 48804</b>	Lampholder
245 1	<b>4812 458 38071</b>	Basket freezer
245 2	<b>4812 458 38069</b>	Basket freezer
245 5	<b>4812 458 38068</b>	Shelf refr.
252 0	<b>4812 404 38646</b>	Panel thermostat
255 0	<b>4812 466 78397</b>	Glas cover
301 0	<b>4812 464 69001</b>	Control panel
301 1	<b>4812 460 48973</b>	Panel
301 2	<b>4812 460 79022</b>	Panel
305 0	<b>4812 412 78813</b>	Knob thermostat
402 0	<b>4819 360 58753</b>	Compressor, EMT 60 HLP
402 1	<b>4819 418 79552</b>	Tray, compressor
500 0	<b>4812 460 38118</b>	Cover CONNECTION BOX
554 0	<b>4812 210 58022</b>	Thermostat ATEAA130595
651 0	<b>4819 134 88135</b>	Lamp E14 220V 15W
652 0	<b>4812 404 48803</b>	Holder, lamp
655 0	<b>4812 263 68003</b>	Pushbutton cam
740 0	<b>4812 511 38184</b>	Condenser
740 1	<b>4812 404 48806</b>	Holder
740 2	<b>4812 404 48807</b>	Holder
740 3	<b>4812 404 38647</b>	Spacer
745 0	<b>4812 511 38186</b>	Evaporator freezer
746 0	<b>4819 526 48527</b>	Dryer
900 0	<b>4812 404 48808</b>	Holder
900 1	<b>4812 404 78485</b>	O-Ring

**Exploded view**

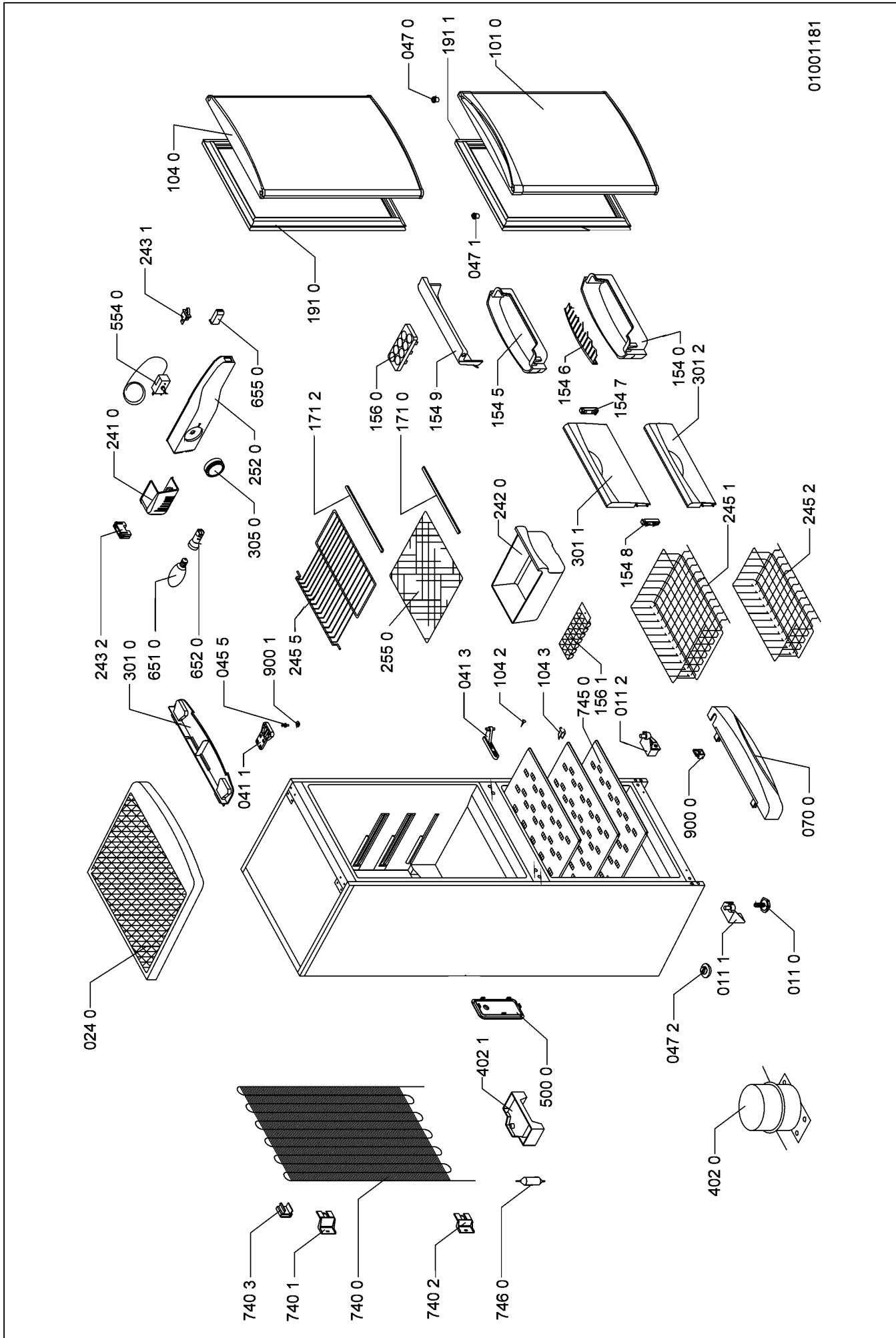

01001181

**Circuit and Wiring diagram**

