

# Service Manual

ORDER NO.  
CRT1362

BRIDGEABLE POWER AMPLIFIER

# GM-2200

## GM-1200

EW, ES

EW, ES

- This additional service manual is designed to be used together with Model GM-H100/UC Service Manual (CRT1343). Refer to it for finding parts numbers, etc. which are not shown in this manual.

## CONTENTS

1. ADJUSTMENT .....	2	5. SCHEMATIC CIRCUIT DIAGRAM	
2. ELECTRICAL PARTS LIST .....	3	(GM-1200/EW, ES) .....	11
3. CONNECTION DIAGRAM (GM-2200/EW, ES) .....	6	6. CONNECTION DIAGRAM (GM-1200/EW, ES) .....	13
4. SCHEMATIC CIRCUIT DIAGRAM		7. EXPLODED VIEW .....	16
(GM-2200/EW, ES) .....	9	8. PACKING METHOD .....	20

## 1. ADJUSTMENT

### ● Connection Diagram

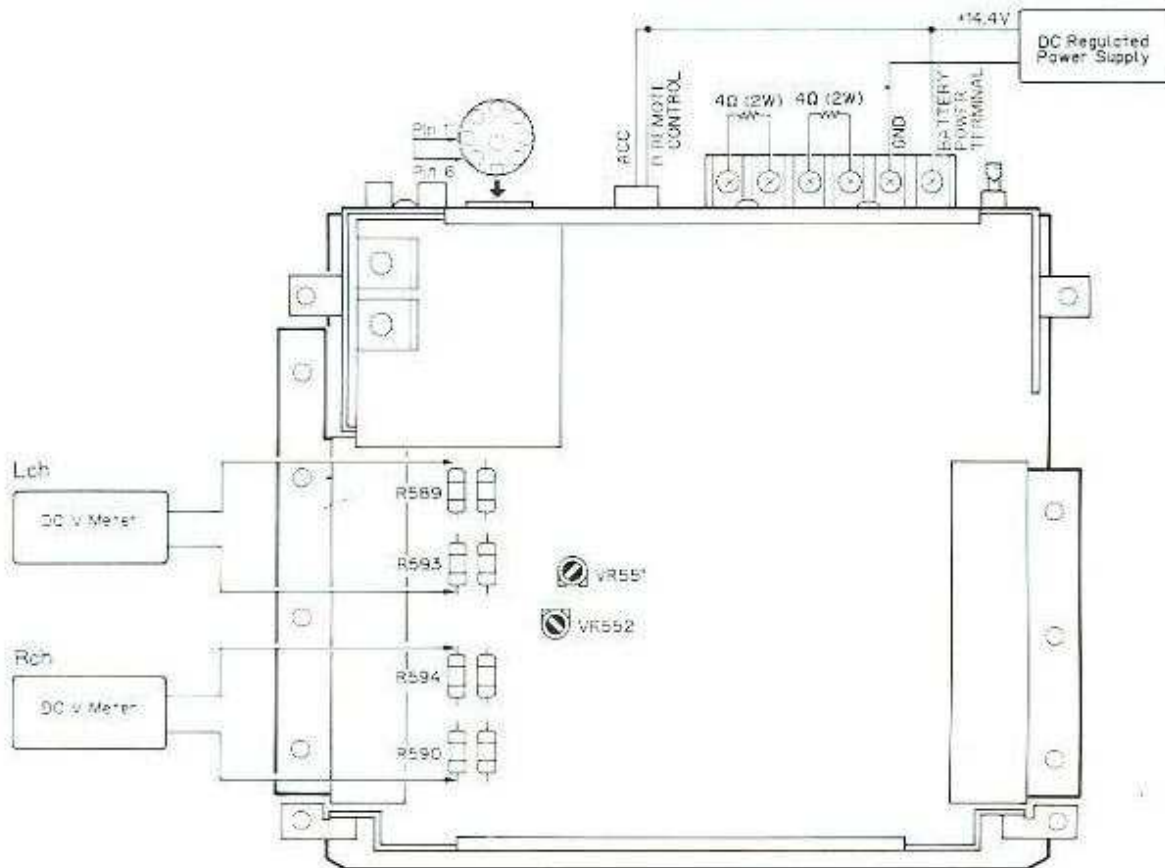

Fig. 1

### 1.1 IDLE CURRENT ADJUSTMENT

No.	Adjusting Point	Adjustment Method (Switch Position)
1		Rotate VR551 and VR552 counterclockwise. Turn the power on and wait about 10 minutes.
2	VR551 (Lch) VR552 (Rch)	DC V Meter: $1.0\text{mV} \pm 2.3\text{mV}$ - $0.34\text{-V}$ (DRIVE MODE SELECT SWITCH : 4Ω)

ES	
OP	R001
7	.....
7	.....
7	.....

IME UNIT

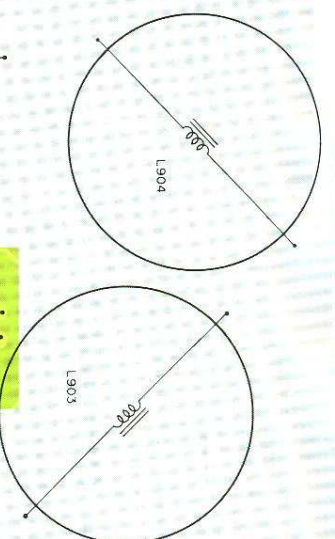
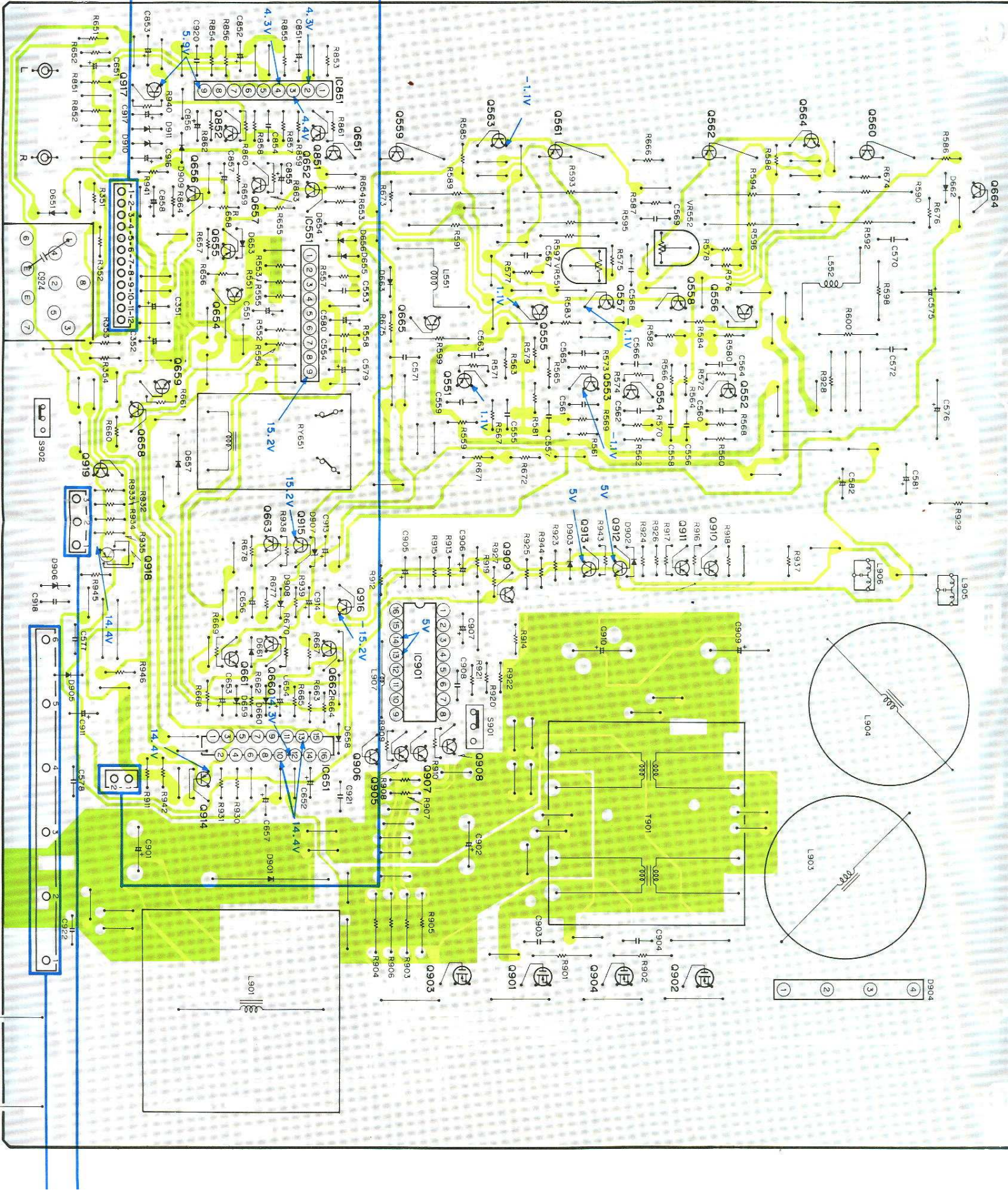

- 1
- 2
- 3
- 4

# 4. SCHEMATIC CIRCUIT DIAGRAM (GM-2200/EW, ES)

A

B

C

D

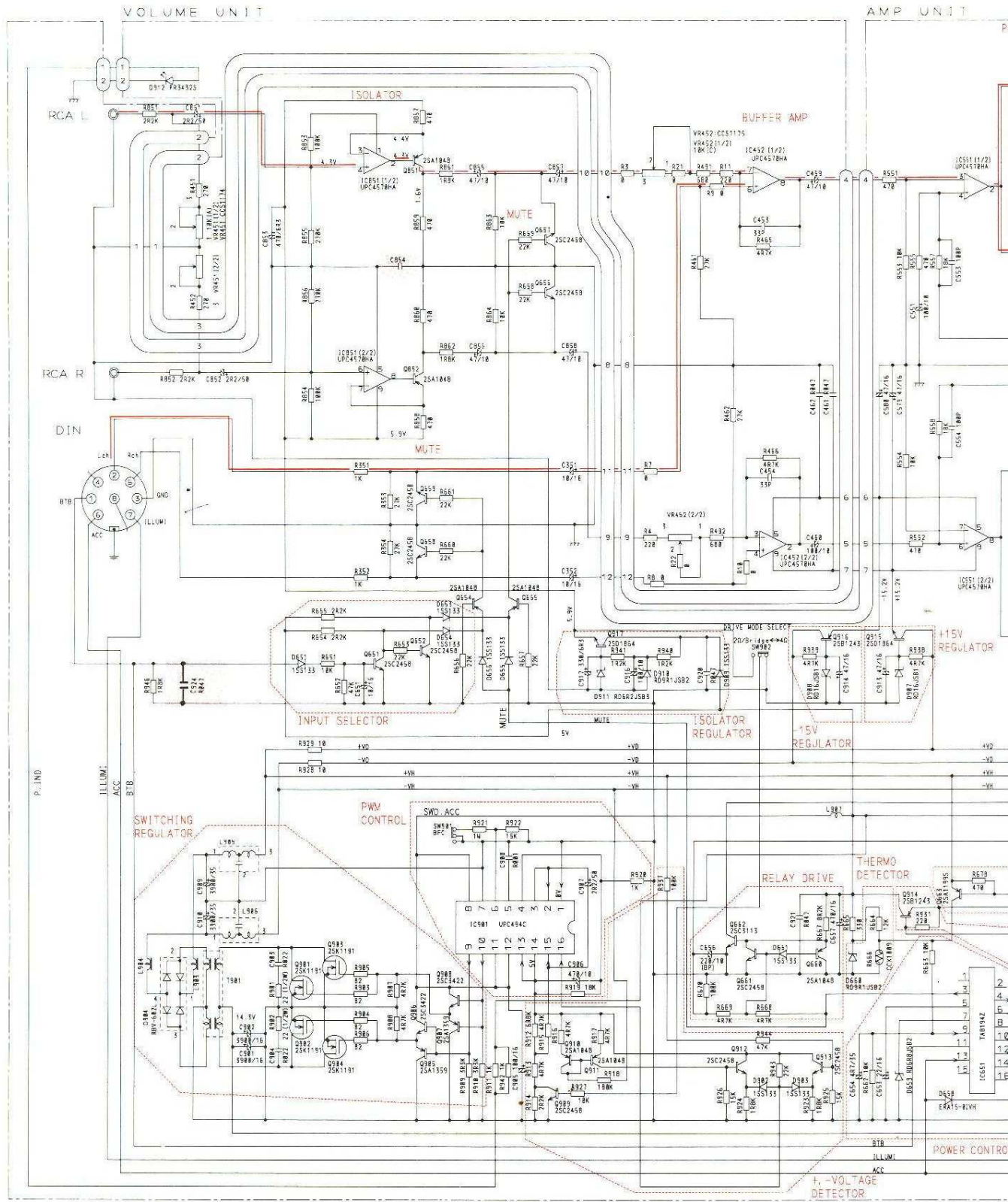

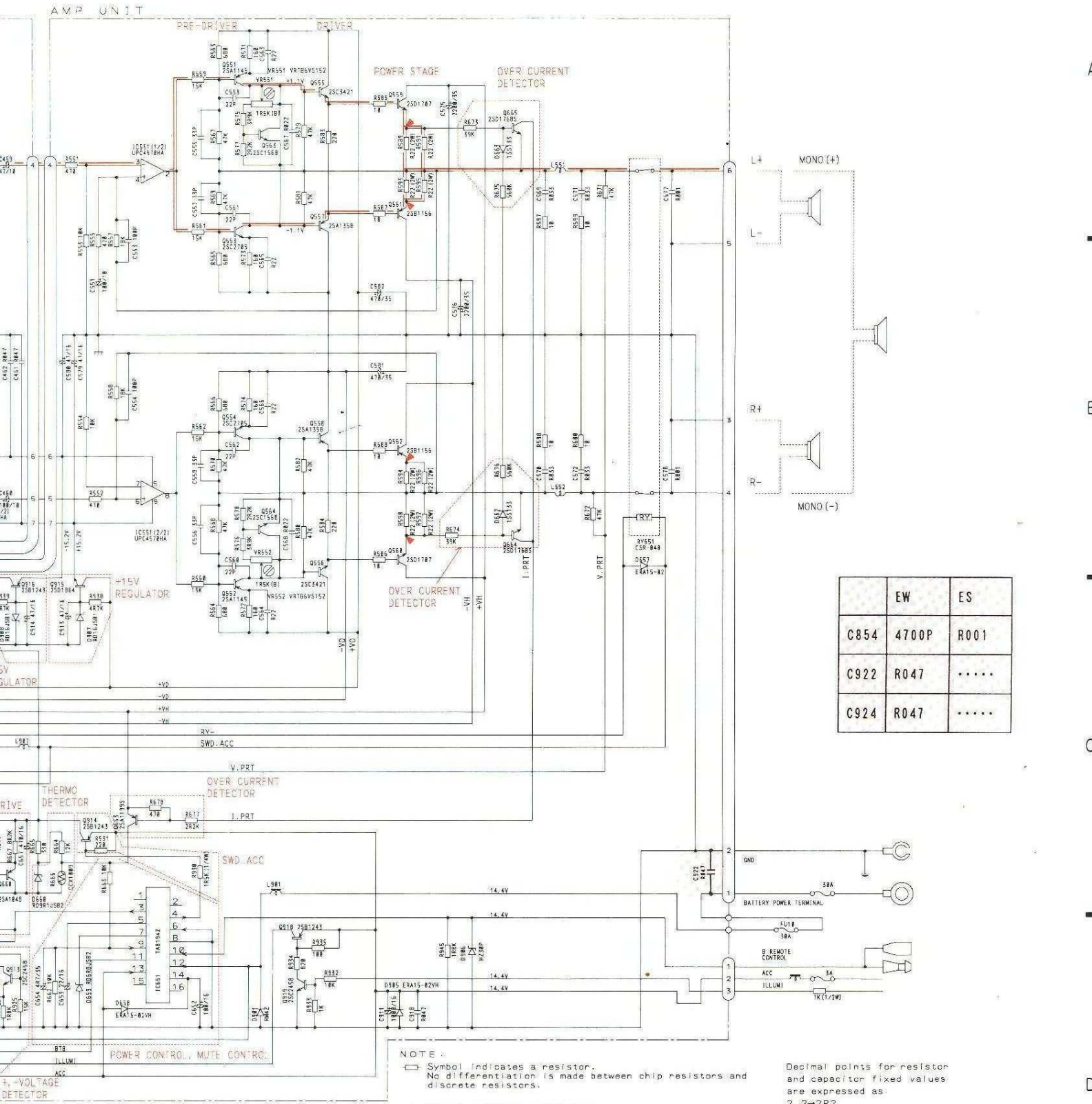

	EW	ES
C854	4700P	R001
C922	R047	.....
C924	R047	.....

**NOTE:**  
 □ Symbol indicates a resistor. No differentiation is made between chip resistors and discrete resistors.  
 -H Symbol indicates a capacitor. No differentiation is made between chip capacitors and discrete capacitors.

Decimal points for resistor and capacitor fixed values are expressed as:  
 2.2→2R2  
 0.022→R022

**SWITCHES:**  
 AMP UNIT  
 SW901 BFC SWITCH ..... LOW-HIGH  
 SW902 DRIVE MODE SELECT SWITCH → 2Ω/Bridge-4Ω  
 The underlined indicates the switch position.

Fig. 3