

10.1.2 Deck layout diagram

Deck in position „threaded out“.

The following diagrams indicate the relative position of the gearwheels and levers when the deck is in the threaded out (cassette-compartment down) position.

Top view

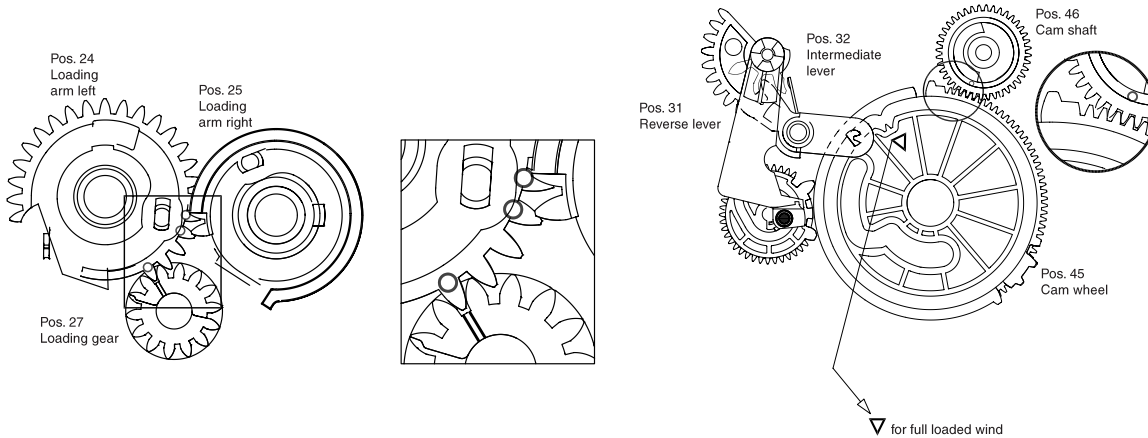

Underside view

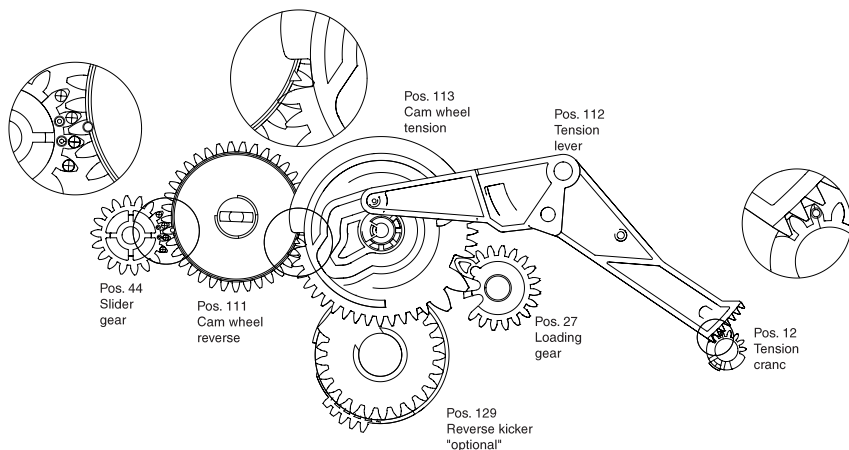

10.1.3 The lift

Refitting the lift compartment:

Ensure the lift compartment is down and gear A is rotated one click stop anticlockwise from the down position.

The removal and refitting of the lift can be carried out in all deck positions with the exception of „eject“ (ensure that gears 103/105 are free and if present the cassette loader gear 2 pos.105 is positioned to the rear).

To remove the lift:

Free the holding bracket (see figure 10-2) by rotating it up and back from the upper end.

Unscrew the 4 screws on the underside of the deck.

Carefully remove the lift vertically, noting the position of the record protect operating lever.

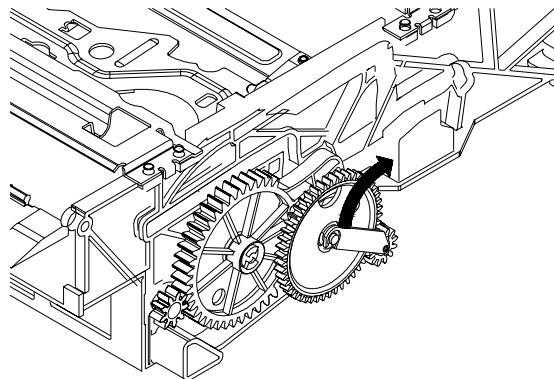

Figure 10-2