

**MODEL No:** J-SC2900

**Description:** 2900 mAh SIZE NI-MH SC

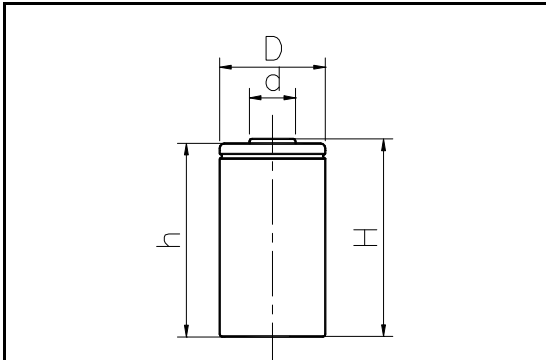

**Dimensions(without Tube) (mm)**

D	22.00±0.10
d	10.00±0.08
H	42.00±0.50
h	41.50±0.50

**Specification**

Nominal Capacity		2900 mAh	
Nominal Voltage		1.2 V	
Charge current	Standard	290 mA	
	Fast	870 mA	
Charge time	Standard	16 Hrs	
	Fast	4 Hrs	
Ambient Temperature	Charge	Standard	0°C~45°C
		Fast	10°C~45°C
	Discharge		-20°C~60°C
	Storage		-20°C~55°C
Internal Impedance(mΩ) (After Charge)		≤ 11	
Weight		53.0 g	

